

MAGNA Black Magnetic track recessed L-joiner

Model No. MSAR12-BLK

Project Details

| | |
|--------------|--|
| Job Name | |
| Location | |
| Type/Qty | |
| Contact Info | |
| Note | |

Features

- For seamless 90 degree Track connection in Recessed applications
- Top quality metal construction
- ETL tested and approved to ensure both safety and quality

SPECIFICATION

| | |
|-----------------------------|------------|
| OAH (in.) | 2.3 |
| Overall Width (in.) | 3.6 |
| OA Depth (in.) | 3.6 |
| Certifications and Listings | ETL Listed |

LED Info



Description

MAGNA Slim-Trac Magnetic Lighting System Magnetic track recessed L-joiner in a Sandy Black finish

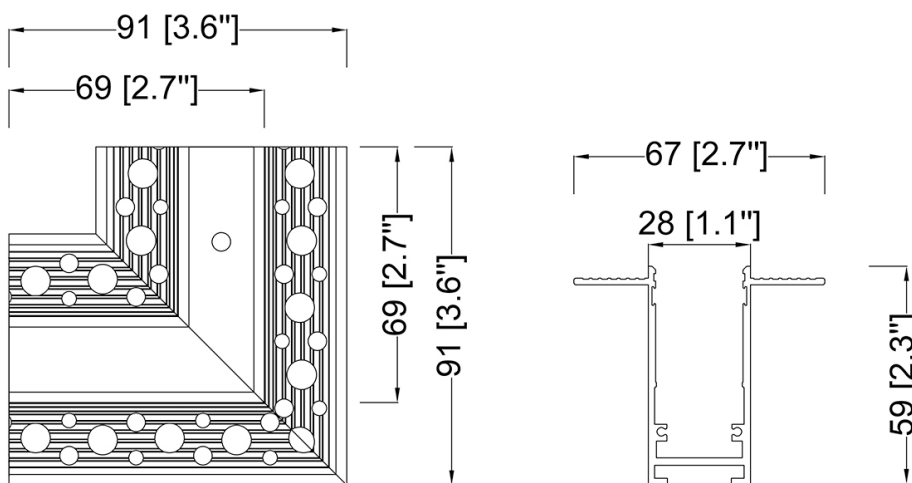

KENDAL Lighting (BC) Inc.

#110, 6780 Dennett Place Delta, B.C. V4G 1N4 Ph: (604) 952-5510 · Toll Free: 1-888-306-3267

info@kendallighting.com www.kendallighting.com