

TRACK CORNER INSTRUCTIONS

MSAS05 CROSS CORNER

ACCESSORIES REQUIRED:

KENDAL MODEL MSAS05



WHICH INCLUDES: 4 × MSA PINS



4 × MSA02 CONNECTORS



KENDAL MODEL MSA01 POWER PLATE IF REQUIRED



DIMENSIONS

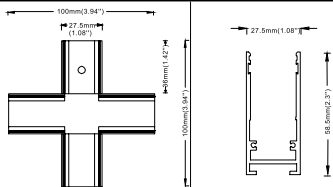

STEP 1 REMOVE END CAP FROM TRACK

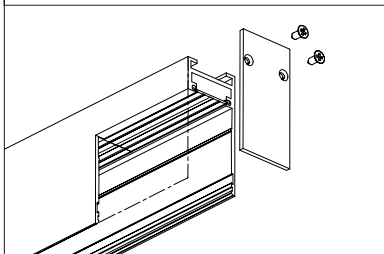

STEP 2 REMOVE DECORATIVE PLATE, IF CONNECTING TO END OF TRACK THAT DOES NOT HAVE A DECORATIVE PLATE SKIP TO STEP 5.

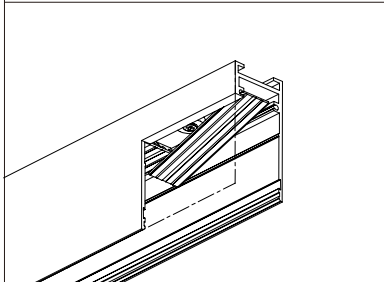

STEP 3 REMOVE MAGNET

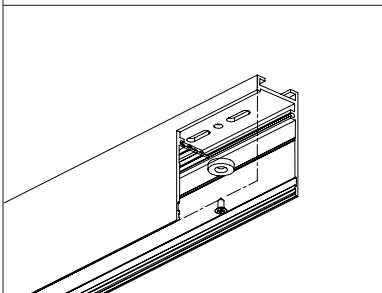

STEP 4 INSERT THE MSA01 POWER PLATE(d) - SOLD SEPARATELY

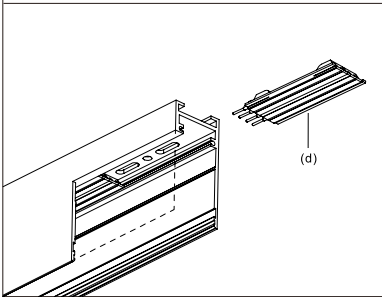

STEP 5 INSTALL THE MSA22 PIN SET(b) INTO THE PIN CONNECTOR HOLES (c) ON THE TRACK. SLIDE THE TRACK CONNECTOR (a) INTO THE SLOT ON THE BACK OF THE TRACK SO THAT THE HOLE ON THE CONNECTOR LINES UP WITH THE SECOND HOLE IN FROM THE END OF THE TRACK AND SECURE WITH 3 SET SCREWS(SEE INSET PICTURE).

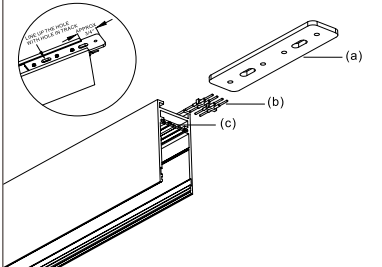

STEP 6 SLIDE MSAS05 TRACK CORNER ONTO THE TRACK CONNECTOR (a) WHILE CAREFULLY LINING UP THE PIN SET WITH THE PIN SET HOLES ON THE MSAS04 TRACK CORNER.

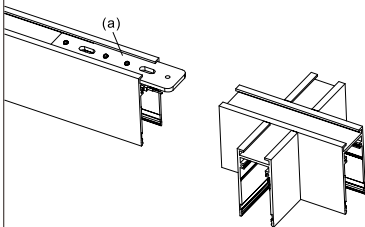

STEP 8 REPEAT STEPS 1 THROUGH 7 FOR OTHER THREE SIDES OF TRACK CORNER AND COMPLETE TRACK CORNER CONNECTION.

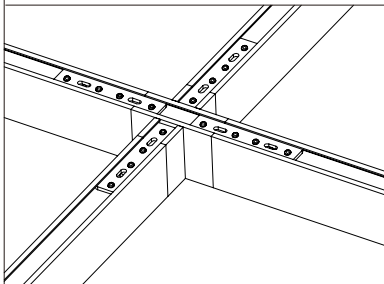

ATTENTION:

WHEN JOINING TRACKS OR ACCESSORIES UTILIZING PIN CONNECTORS, MAKE SURE PINS ARE HORIZONTAL AND LINE UP WITH PIN CONNECTOR HOLES. YOU MAY NEED TO GENTLY PUSH UP OR DOWN ON THE PINS SO THEY LINE UP CORRECTLY. FAILING TO DO THIS MAY RESULT IN PINS MISSING THE PIN CONNECTOR HOLES AND LOSS OF THE 24 VOLT CONNECTION.

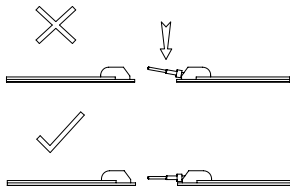

NOTE:

AFTER EACH TRACK CONNECTION A CONTINUITY TEST SHOULD BE DONE TO ENSURE PROPER ELECTRICAL CONNECTIONS WERE MADE.

STEP 7 SECURE OTHER END OF TRACK CONNECTOR (a) TO THE TRACK CORNER WITH REMAINING SET SCREW

